

**3-MIDD LEVEL**  
+13'-0" ELEVATION

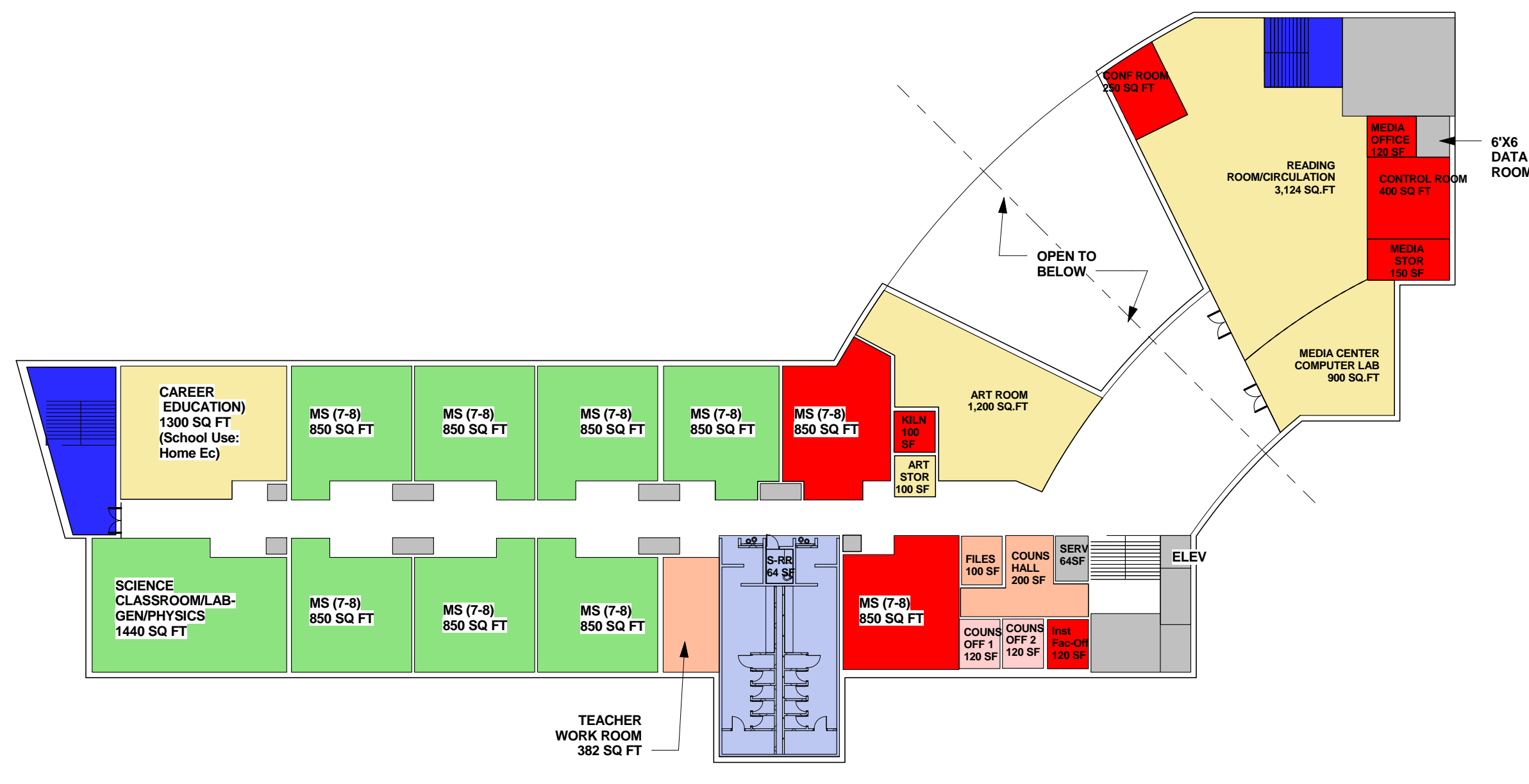

**4-TOP LEVEL**  
+26'-0" ELEVATION

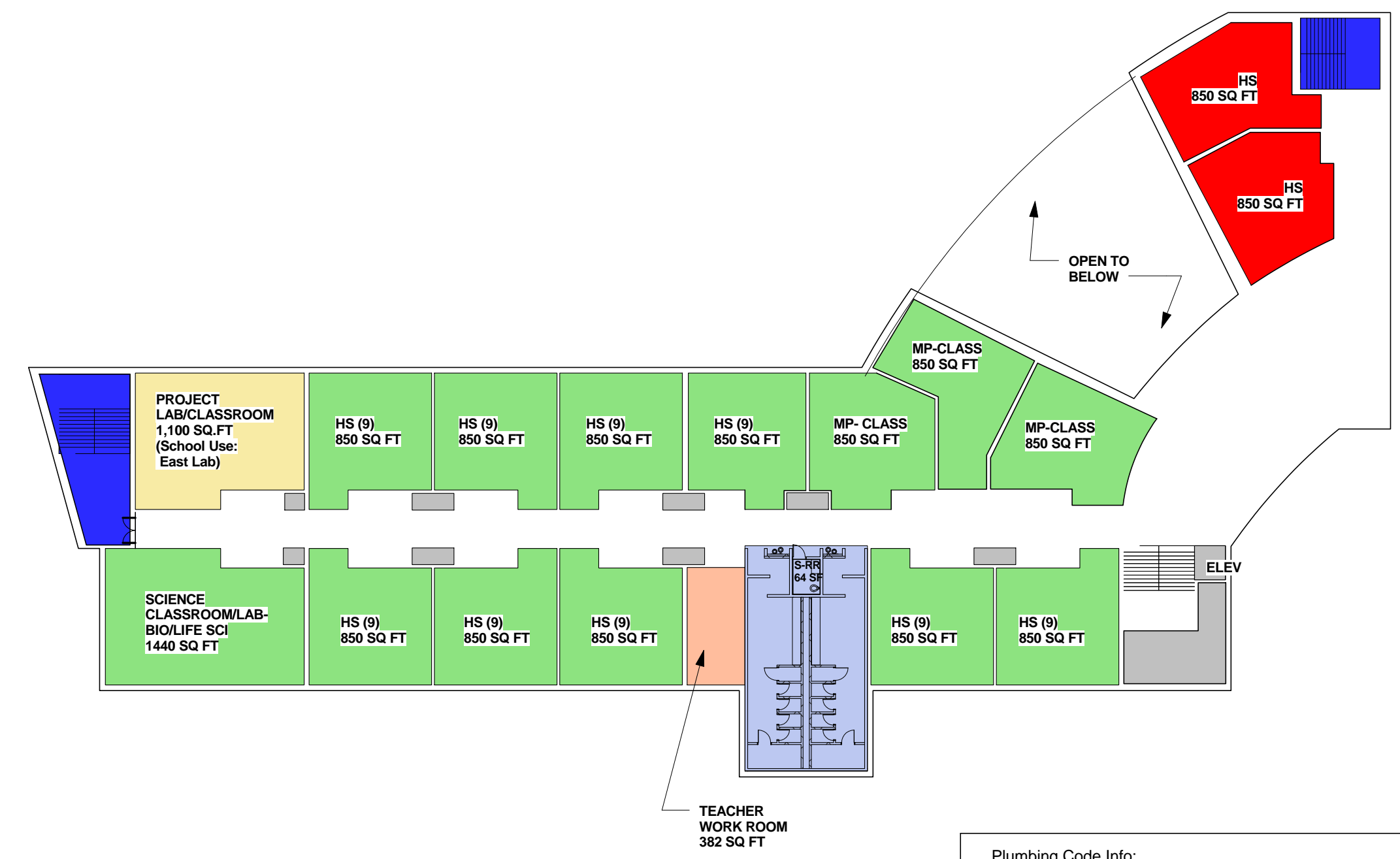

**2-MAIN LEVEL**  
0'-0" ELEVATION

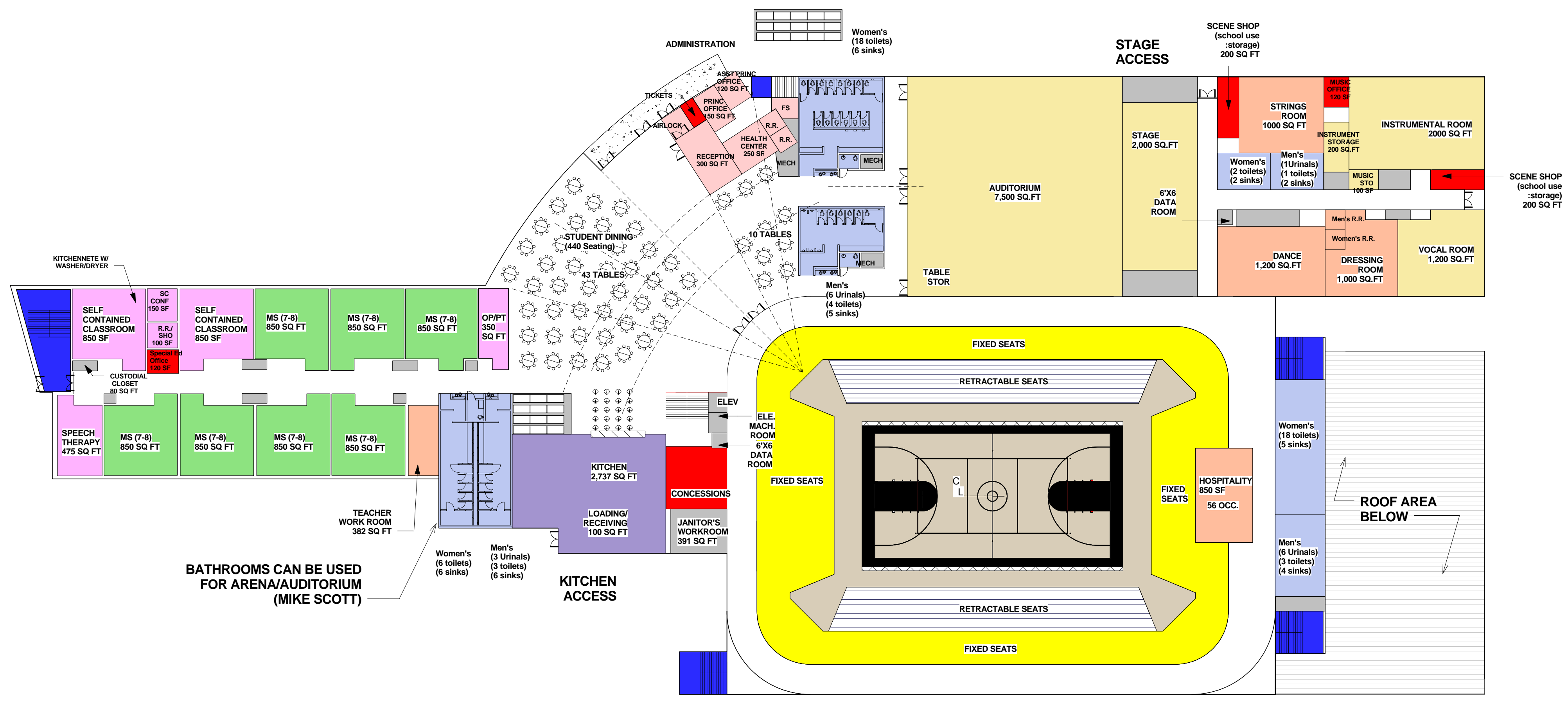

**1-BOTTOM LEVEL**  
-15'-0" ELEVATION

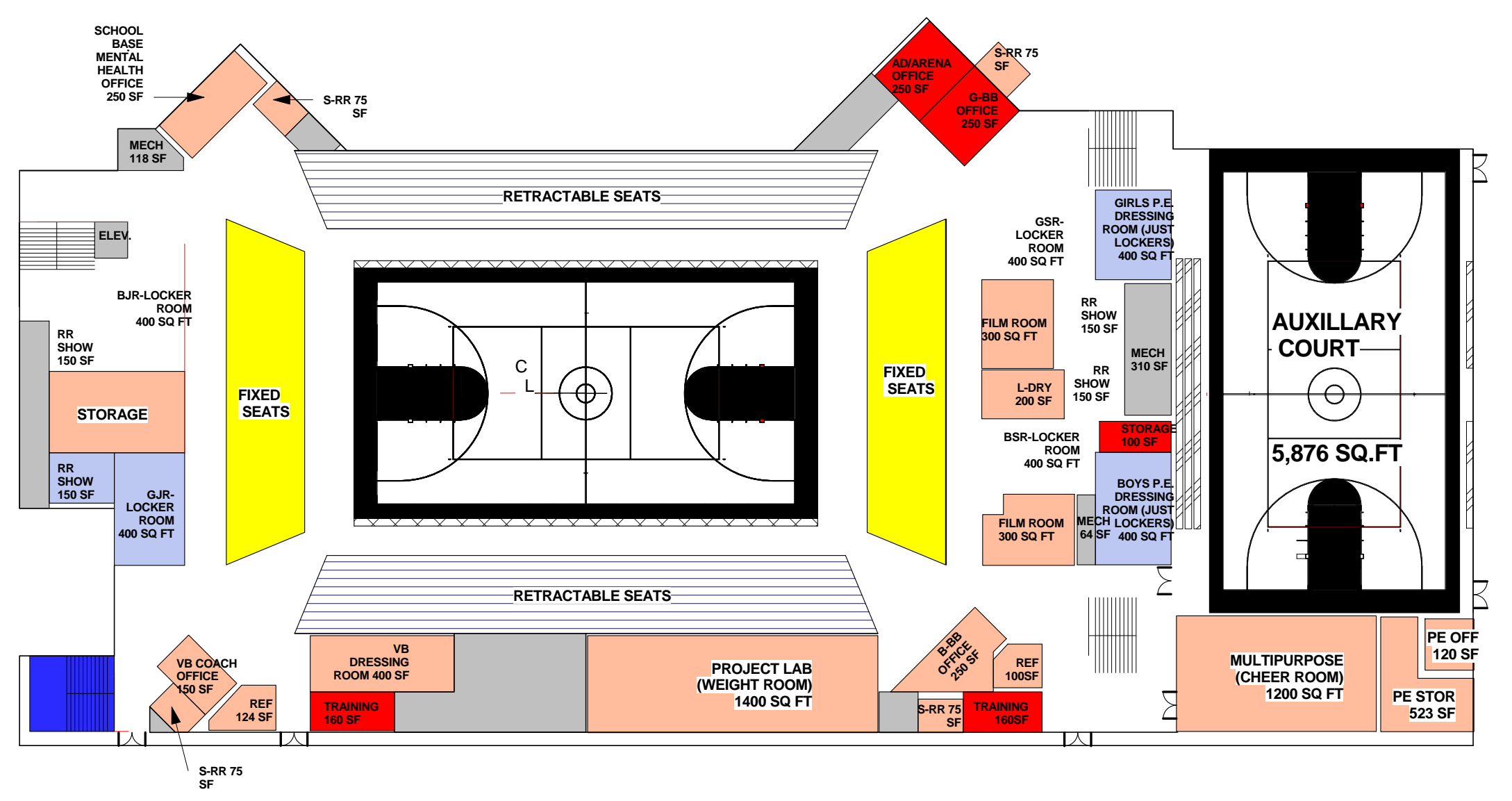

Plumbing Code Info:  
Arena (2200 Occupancy):

Water Closets:  
Male: 1 per 75 for the first 1,500 (1100/75 = 15)  
1 per 120 for the remaining  
Female: 1 per 40 for the first 1520 (1100/40 = 28)  
1 per 60 for the remaining

Lavatories:  
Male: 1 per 200 (1100/200 = 6)  
Female: 1 per 150 (1100/150 = 8)

Auditorium (1000 Occupancy):

Water Closets:  
Male: 1 per 125 (500/125 = 4)  
Female: 1 per 65 (500/65 = 8)

Lavatories:  
Male: 1 per 200 (500/200 = 3)  
Female: 1 per 200 (500/200 = 3)

Classrooms (Occupancy)

3-TOP Level (975 Occupancy)

16 Classrooms	(850)
Project Lab	(1,100)
Science Classroom	(1,440)
Art Room	(1200)
Media Lab	(900)
<b>Total</b>	<b>18,240/20 net = 912 Occupants</b>

Reading Room (3124)/50 net = 63 Occupants

Total Occupant load for 3-Top Level: 912 + 63 = 975

Water Closets:  
Male: 1 per 50 (488/50 = 10) (6 urinals, 4 toilets)  
Female: 1 per 50 (488/50 = 10)

Lavatories:  
Male: 1 per 50 (488/50 = 10)  
Female: 1 per 50 (488/50 = 10)

2-MAIN Level (1,087 Occupancy)

13 Classrooms	(850x13)
Career Education	(1300)
Science Classroom	(1440)
2 Self Contained Classrooms	(850x2)
<b>Total</b>	<b>15,490/20 net = 775 Occupants</b>

Water Closets:  
Male: 1 per 50 (388/50 = 8) (5 urinals, 3 toilets)  
Female: 1 per 50 (388/50 = 8)

Lavatories:  
Male: 1 per 50 (388/50 = 8)  
Female: 1 per 50 (388/50 = 8)

Self Contained

Conference	(150)
OP/PT	(350)
Speech Therapy	(475)
<b>Total</b>	<b>975/100 gross = 10 Occupants</b>

(1 unisex restroom for Self Contained)

Kitchen 2737/200 gross = 14 Occupants  
(1 unisex restroom for Kitchen)

Admin: 1550/100 gross = 16 Occupants  
(1 unisex restroom for Admin)

Music:

Strings Room	(1000)
Vocal Room	(1,200)
Dance	(1,200)
Instrumental Room	(2000)
<b>Total:</b>	<b>5400/20 net = 270 Occupants</b>

Music Office 120/100 = 2 Occupants

Water Closets:  
Male: 1 per 50 (136/50 = 3) (2 urinals, 1 toilet)  
Female: 1 per 50 (136/50 = 3)

Lavatories:  
Male: 1 per 50 (136/50 = 3)  
Female: 1 per 50 (136/50 = 3)

Total Occupant load for 2-Main Level: 775 + 10 + 14 + 16 + 270 + 2 = 1087

Level 1 - Dependent 5 3story down  
1" = 30'-0"

12-12-2016